

3.5mm Male to 2.92mm Male, Adapter, RA3405-2 DC-34GHz, Straight

Dimensions(mm) Tolerance $\pm 1\%$

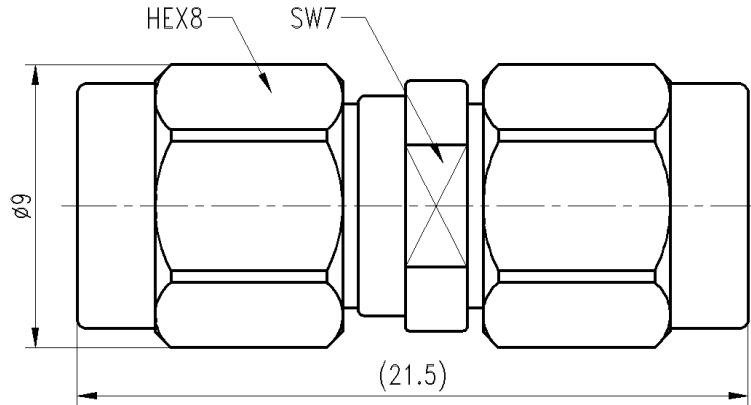

Electrical & Environmental

Frequency Range	DC-34GHz	Impedance	50 ohm
VSWR	1.2 max (26.5-34GHz); 1.15 max (DC-26.5GHz)	Operating Temp	-55°C to +165°C

Mechanical & Product Information

Product Number	RA3405-2, JP-Grade	Connector	3.5mm Male to 2.92mm Male
Connector Body	Passivated stainless steel 316F	Shape/Mounting	Straight, None
Center Contact	1.27um gold plated beryllium copper	Insulator	PEI

