

3.5mm Female to 3.5mm Female, Adapter, RA3401FSE DC-34GHz, 4 hole flange

Dimensions(mm) Tolerance $\pm 1\%$

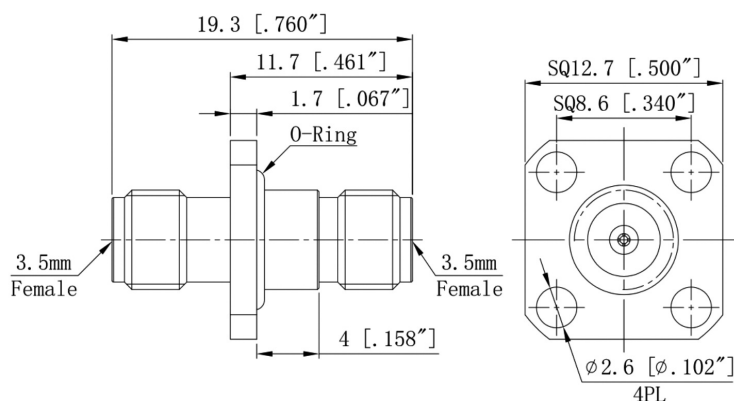

Electrical & Environmental

Frequency Range	DC-34GHz	Impedance	50 ohm
VSWR	1.2 max , Typ 1.15	Insertion Loss	-

Mechanical & Product Information

Product Number	RA3401FSE, P-Grade, Sealing ring	Connector	3.5mm Female to 3.5mm Female
Connector Body	Passivated stainless steel	Shape/Mounting	Straight, 4 hole flange
Center Contact	Gold plated beryllium copper	Insulator	PEI
Dimension	19.3(L)mm	Net Weight	-