

## SMA Male to SMA Female, Adapter, RA18S03W DC-18GHz, Right Angle

Dimensions(mm) Tolerance $\pm 1\%$

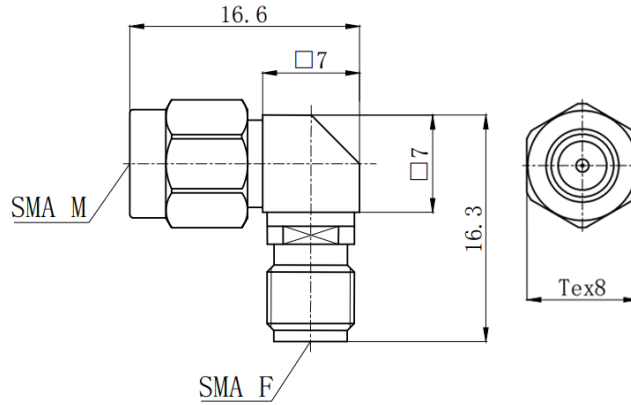

### Electrical & Environmental

Frequency Range	DC-18GHz	Impedance	50 ohm
VSWR	1.25 max	Operating Temp	-55°C to +165°C
Insertion Loss	0.30dB max		

### Mechanical & Product Information

Product Number	RA18S03W, E-Grade	Connector	SMA Male to SMA Female
Connector Body	Passivated stainless steel	Shape/Mounting	Right Angle, None
Center Contact	Gold plated beryllium copper	Insulator	PTFE

### Typical Test Data

