

SMP(GPO) Female to SMP(GPO) Female, Adapter, RA12P01-GBC DC-12.4GHz, Straight

Dimensions(mm) Tolerance $\pm 1\%$

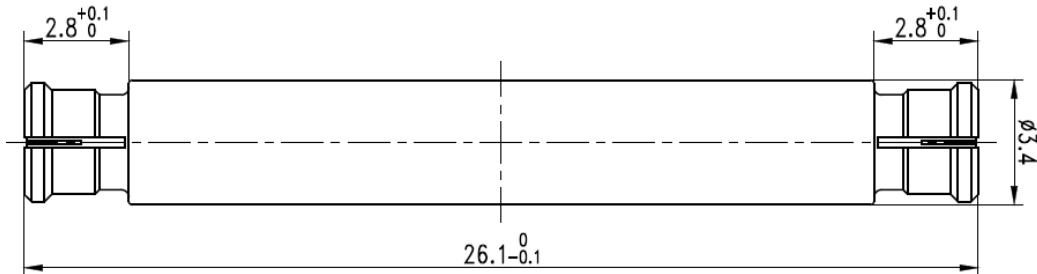

Electrical & Environmental

Frequency Range	DC-12.4GHz	Impedance	50 ohm
VSWR	1.2 max	Operating Temp	-40°C to +155°C

Mechanical & Product Information

Product Number	RA12P01-GBC, JP-Grade	Connector	SMP(GPO) Female to SMP(GPO) Female
Connector Body	Gold plated beryllium copper	Shape/Mounting	Straight, None
Center Contact	1.27um gold plated beryllium copper	Insulator	PTFE

