

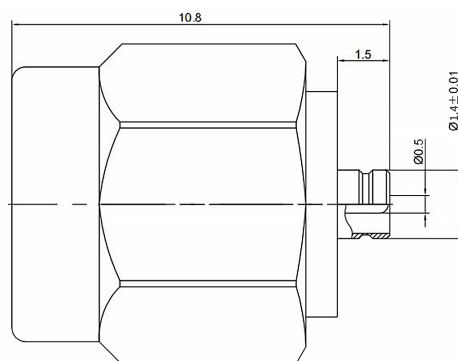

## SMA Male to IPEX Male, Adapter, RA06S1503 DC-6GHz

### Dimensions(mm) Tolerance $\pm 1\%$



### Electrical & Environmental

Frequency Range	DC-6GHz	Impedance	50 ohm
VSWR	1.2 max	Insertion Loss	-

### Mechanical & Product Information

Product Number	RA06S1503, E-Grade	Connector	SMA Male to IPEX Male
Connector Body	Passivated stainless steel	Shape/Mounting	Straight, None
Center Contact	Gold plated beryllium copper	Insulator	PTFE
Dimension	10.8(L)mm	Net Weight	About 2.2g