

SMA Male to IPEX Male, Adapter, RA06S15-1 DC-6GHz, Straight

Dimensions(mm) Tolerance $\pm 1\%$

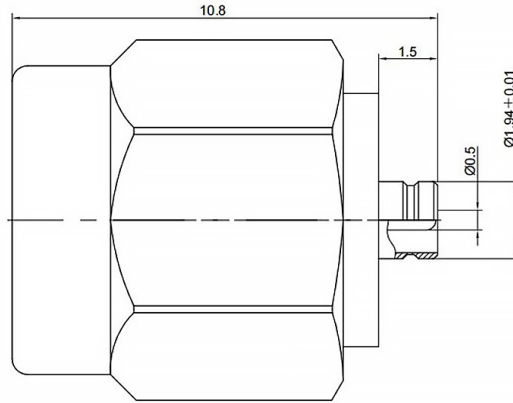

Electrical & Environmental

Frequency Range	DC-6GHz	Impedance	50 ohm
VSWR	1.2 max	Operating Temp	

Mechanical & Product Information

Product Number	RA06S15-1, E-Grade	Connector	SMA Male to IPEX Male
Connector Body	Passivated stainless steel	Shape/Mounting	Straight, None
Center Contact	Gold plated beryllium copper	Insulator	PTFE

